

SQUARE FOOTAGE INFORMATION	
1ST FLOOR HIG.	1502 S.F.
1ST FLOOR NON HIG.	1100 S.F.
2ND FLOOR HIG.	2102 S.F.
2ND FLOOR NON HIG.	424 S.F.
3RD FLOOR HIG.	2057 S.F.
3RD FLOOR NON HIG.	654 S.F.
2ND FLOOR HIG.	1134 S.F.
2ND FLOOR NON HIG.	578 S.F.
TOTAL HIG.	2391 S.F.
TOTAL NON HIG.	4311 S.F.
TOTAL UNDER ROOF:	

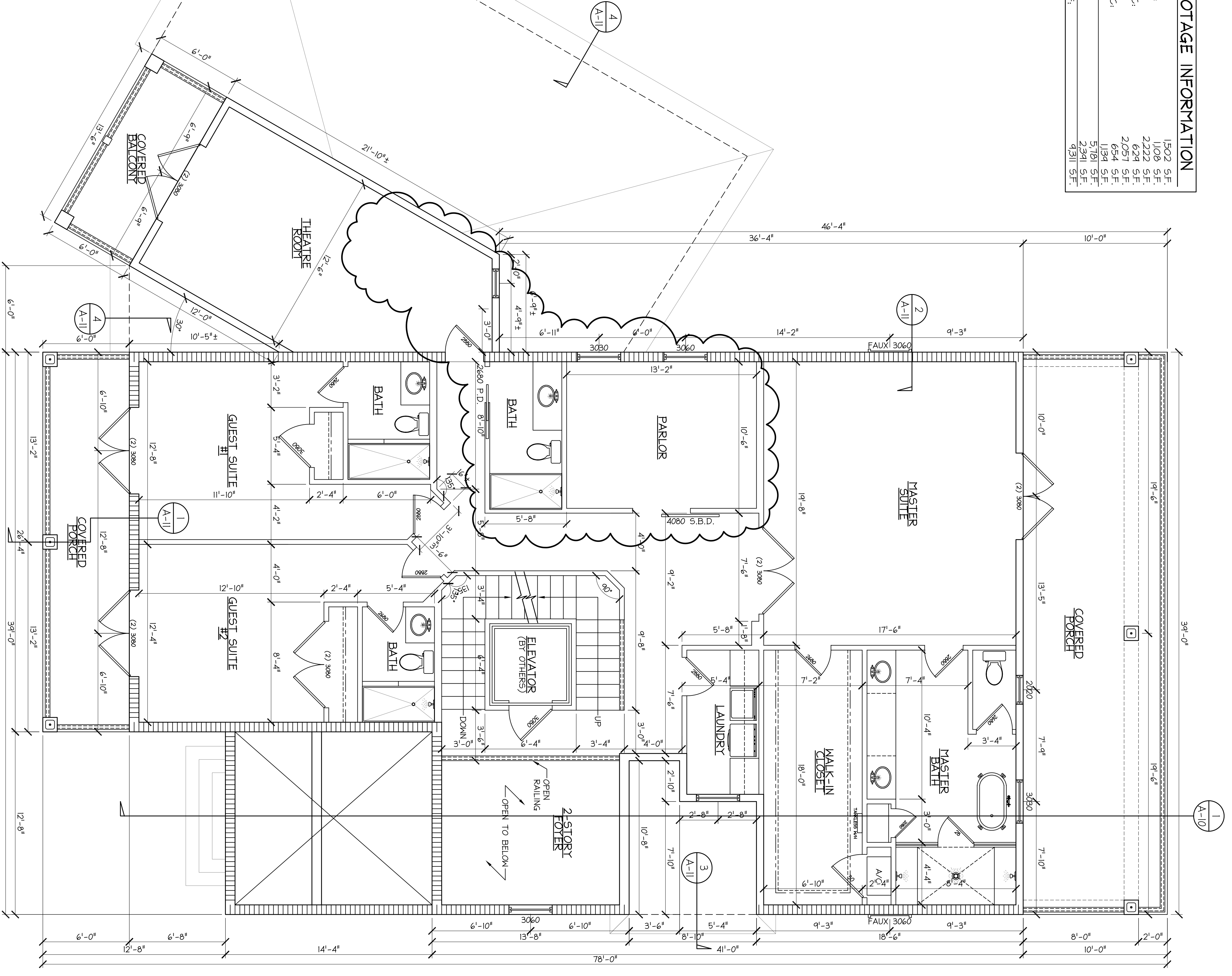

SECOND FLOOR PLAN
SCALE: 1/4" = 1'-0"

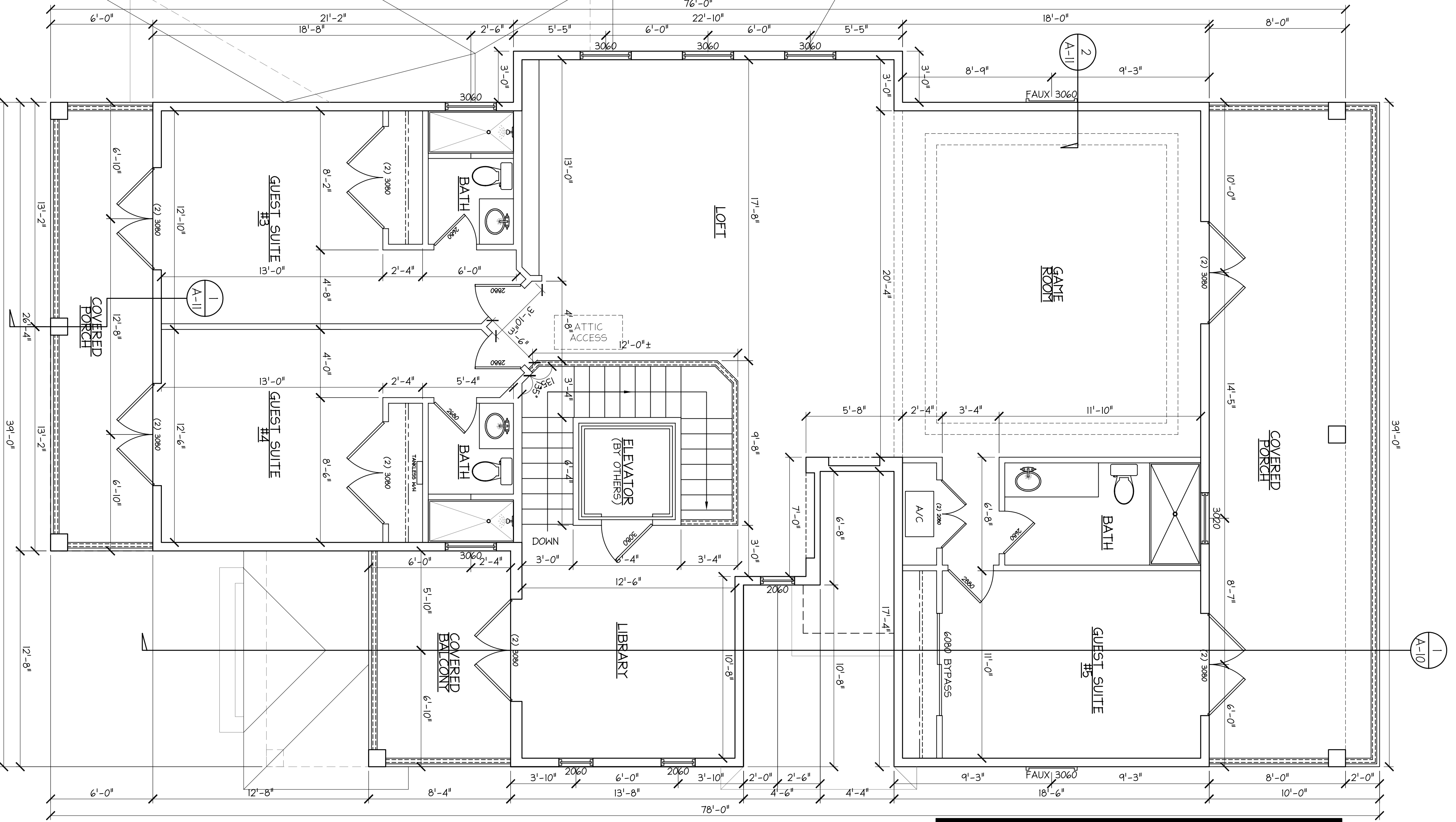

THIRD FLOOR PLAN
SCALE: 1/4" = 1'-0"



NEW RESIDENTIAL PLANS FOR:
JEAN-MARC & TARA MARCHAND
 333 OCEAN CREST DRIVE
 PALM COAST, FLORIDA



REVISIONS	BY

DATE: 12/28/2016
 SCALE: AS SHOWN
 DRAWN: BGH
 SHEET: A-3
 OF SHEETS: 5